

# INSTALLATION INSTRUCTIONS

## Trench Cover Aperture Cutting and Lamination

Tools	Materials	Health & Safety
<p>Jigsaw (Diamond Cutting Blade)</p> <p>Mixing Stick</p> <p>Or</p> <p>Grinder</p> <p>Brush</p> <p>Or</p> <p>Hole Saw (Bi-Metal)</p> <p>Roller</p>	<p>Flex Seal Can</p> <p>Acetone</p> <p>Sandpaper</p>	<p>Overalls</p> <p>Chemically Resistant Gloves</p> <p>Chemically Resistant Eye Protection</p> <p>Well Ventilated</p> <p>Dry</p> <p>Shaded</p> <p>Incase of inadequate ventilation use suitable respiratory equipment</p> <p>Refer to the Health and Safety Data Sheets for further details</p>

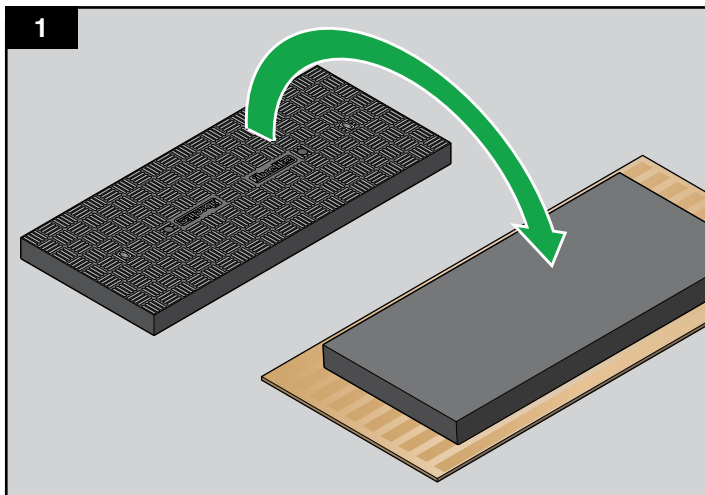

1  
Carefully place the upturned cover onto a cardboard base to prevent damage to the covers treaded surface.

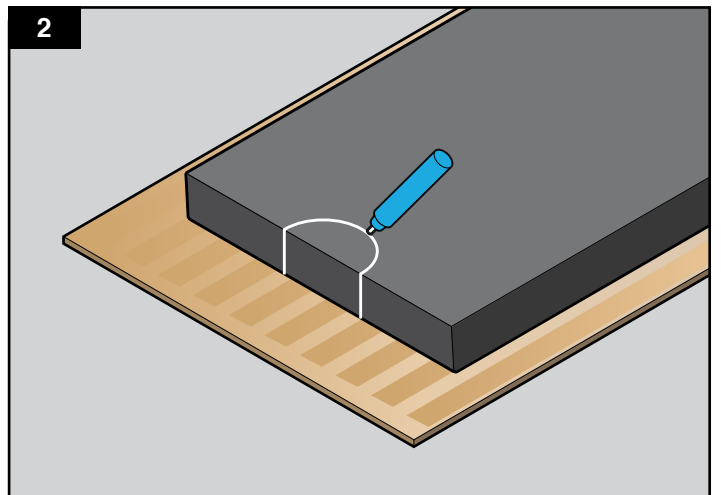

2  
Mark out the necessary aperture.

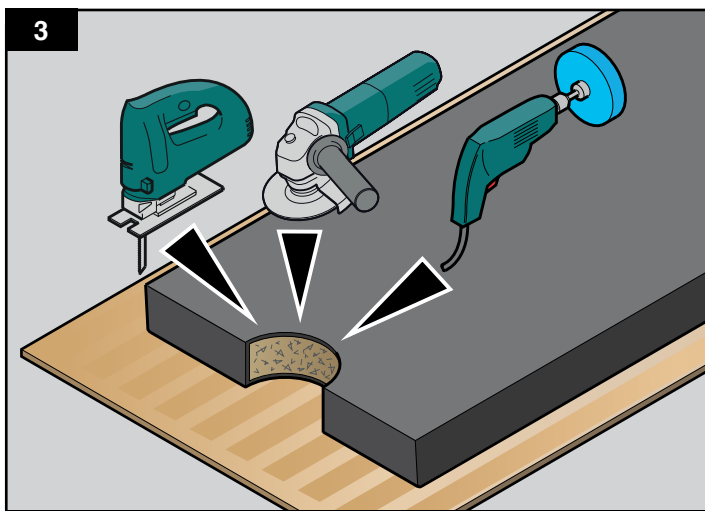

3  
**NB: Cut from the base of the cover not the tread pattern surface**  
Cut out the aperture using either a hole saw (bi-metal), jigsaw (diamond cutting blade) or an angle grinder.

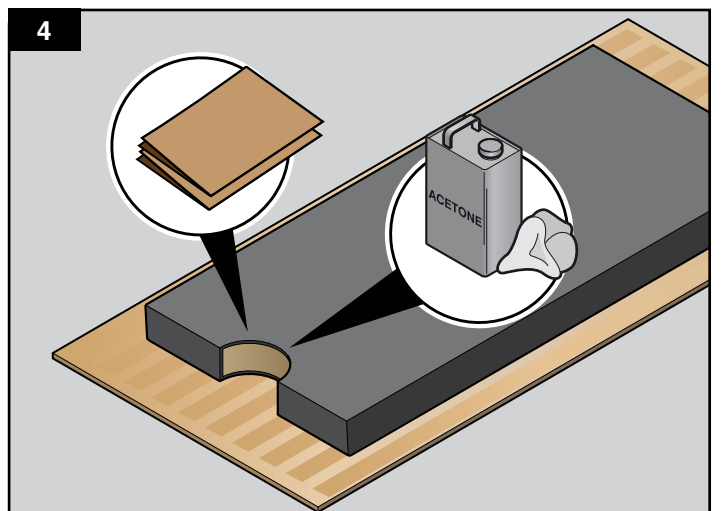

4  
Thoroughly abrade the exposed fibreglass surface and degrease with a degreasing agent (acetone).

