

To ensure satisfaction of operation, it is essential that certain maintenance elements are carried out on a regular basis to assist with Management / Monitoring of the information to assess the integrity of the system.

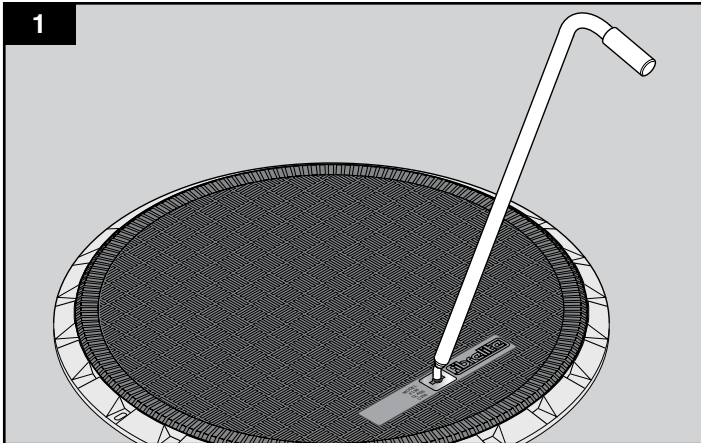

1
The purpose designed lifting aid (FL7) must be used at all times to remove and replace the Fibrelite cover. Failure to use the specifically designed lifting aid may result in damage to the cover and injury.

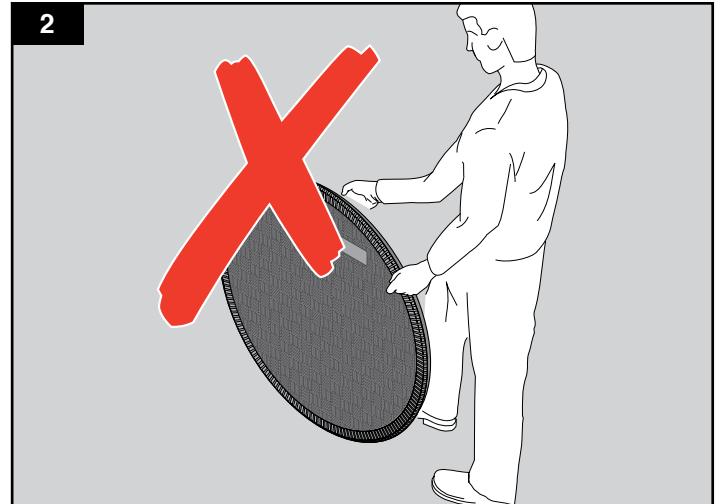

2
Never attempt to roll the cover as this may damage the cover.

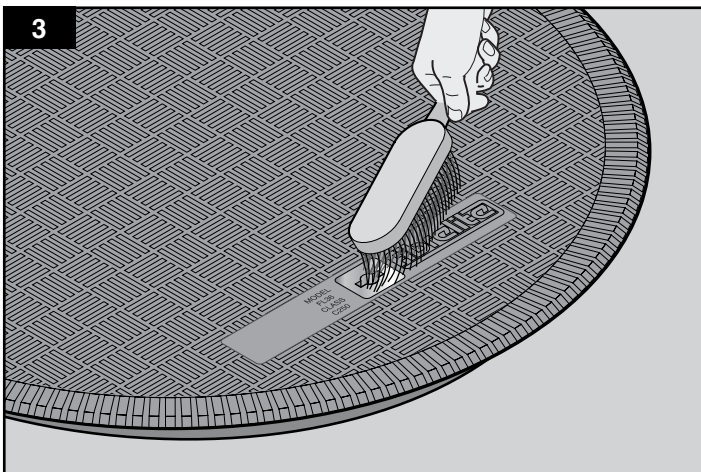

3
Do not remove the rubber bung from the base of the cover key housing. Remove debris from the key housing with suitable tools.

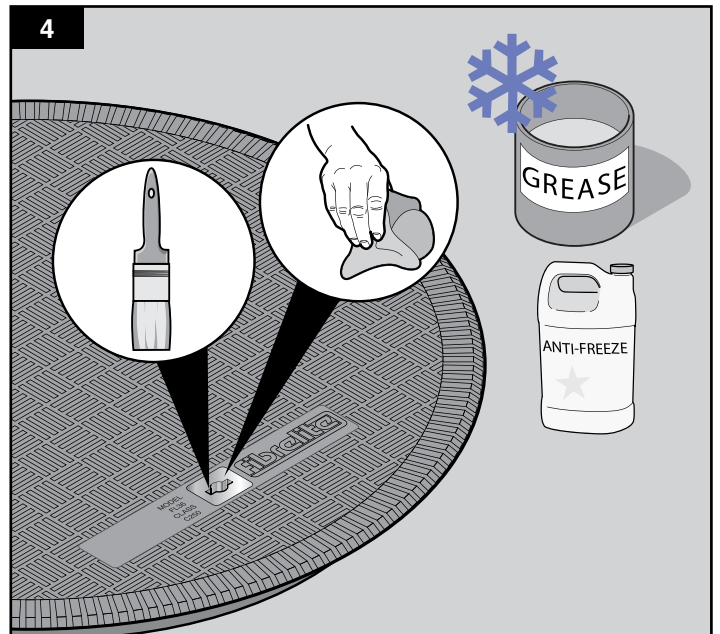

4
It is recommended that the key housing be filled with grease or antifreeze in climates that drop below freezing (0°C - 32°F).

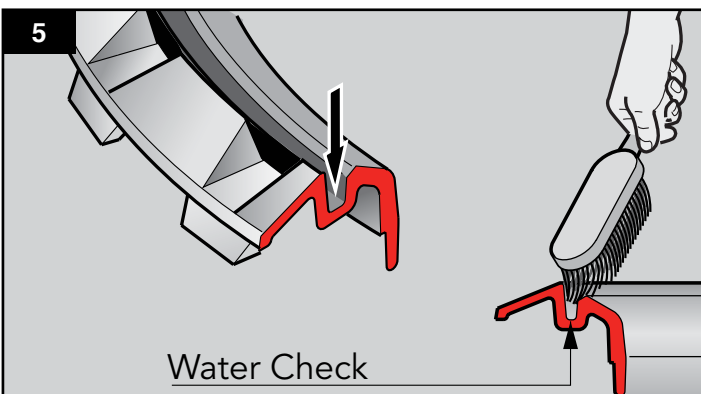

5
The frame water check channel must be kept free from debris. It is recommended that the water check channel be cleaned with a brush on a regular basis.