

Mark out the lateral and vertical position of the pipe on the sump wall. The exit position of the pipework through the sump wall must be as close as possible to 90° and must not exceed 12° from centre line (24° inclusive angle).

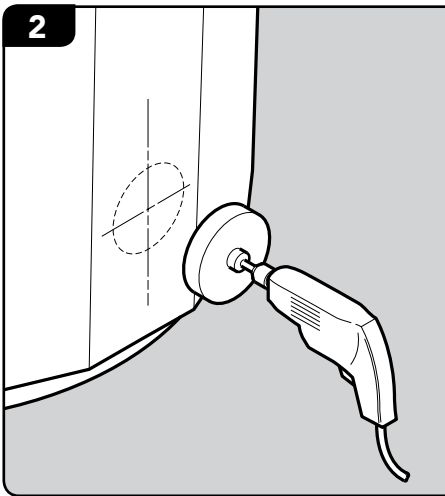

Where appropriate, it is recommended that a drill piloted holesaw be used to cut the pipe seal entry hole, Ø150mm, in the sump.

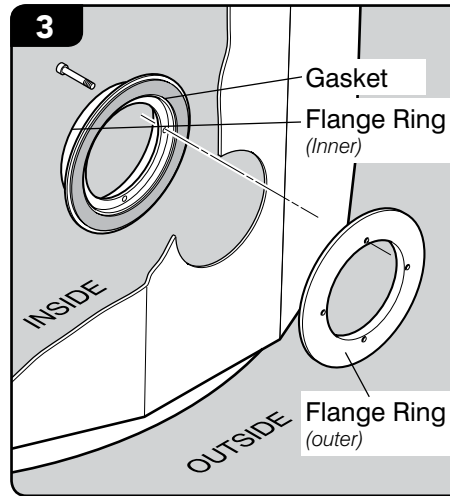

Ensure that the gasket is attached to the flange ring which fits on the inside of the chamber wall. Assemble the flange ring set as per diagram.

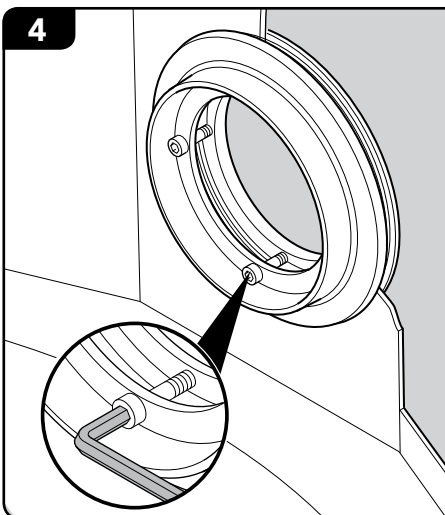

Tighten the socket cap screws with an Allen key.

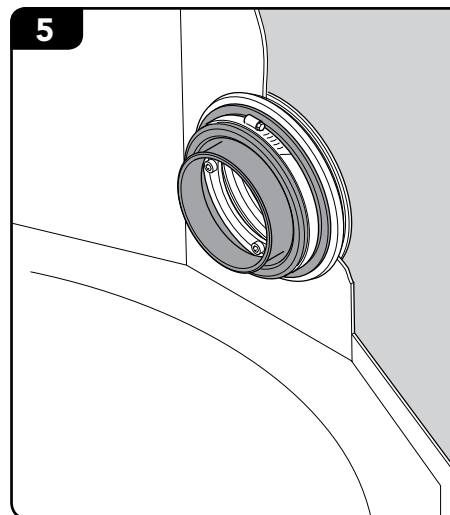

Fit the entry boot to the flange ring and secure with the flange ring clip provided. Tighten clips.

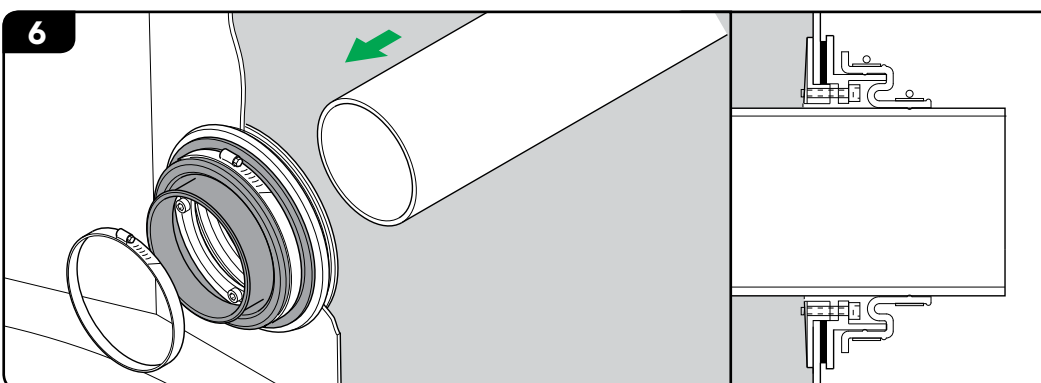

Fit the 100mm diameter ducting into the gaiter and secure the clip.

Installation of Sealkit and Cables

7

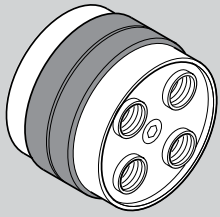

Main Body Qty. 1



Threaded Hexagonal Nut Qty. 4



Standard Doughnut Qty. 4 accommodates single cable Ø9mm to Ø20mm



Multiple Doughnut Qty. 4 accommodates 3 cables Ø5mm to Ø8mm

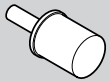

Blind Insert Qty. 5



Plain washer Qty. 8 (For use on Standard Doughnut)

NB: Any doughnut opening not used must be sealed off using the plastic blind insert.

8

x 1 CABLE

1 No. hole
Ø9mm - Ø20mm

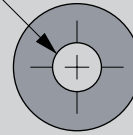

Standard Doughnut

x 1,2,3 CABLE

3 No. holes
Ø5mm - Ø8mm
on 14PCD

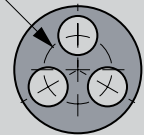

Multiple Doughnut

Determine the number and size of cables to be routed through the entry sealkit. Fit the appropriate rubber doughnut (standard or multiple) into the recess of the main body. Ensure there is a washer either side of the doughnut. (standard only).

9

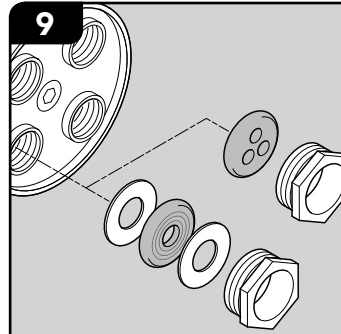

Ensuring there is a washer either side of the rubber (standard only) doughnut. Finger tighten the threaded hexagonal nut into the main body insert.

10

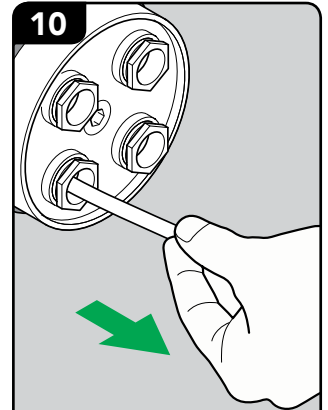

Pull the cables through the doughnut openings.

11

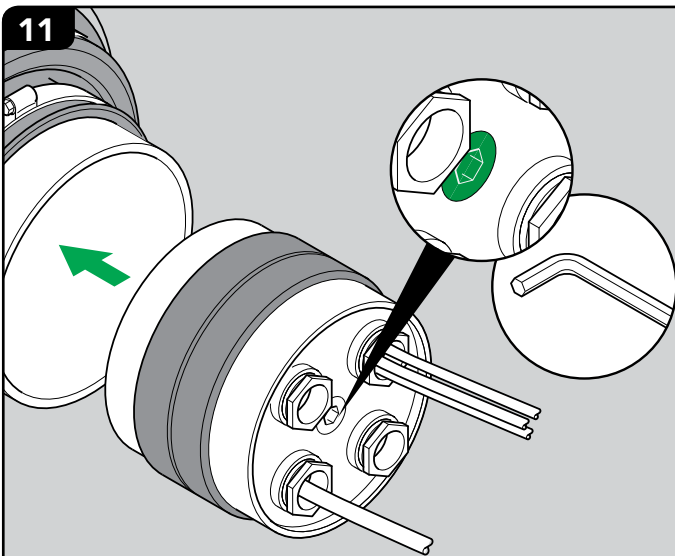

Fit the main body into the ducting. When in position, lock the main body in place by tightening the M8 socket cap screw in the centre of the main body (6mm allen key). Expanding the main body bellows against the internal diameter of the ducting to create a seal.

12

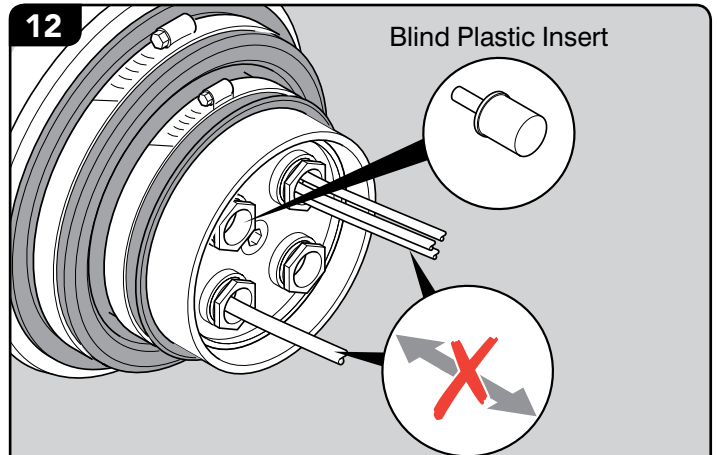

When the position of the cables is finalised tighten the threaded hexagonal nut until the cables are sealed in the doughnut opening(s). This is achieved when the cable **CANNOT** be moved inside the doughnut.