

# FITTING INSTRUCTIONS

## PCE-2 Cable Entry Sealkit

# FIBRELITE

PART OF OPW A DOVER COMPANY

1

Mark out the lateral and vertical position of the pipe on the sump wall. The exist position of the pipework through the sump wall must be as close as possible to 90 degrees. The angle of the flexible entry sleeve must 90° to the sump wall.

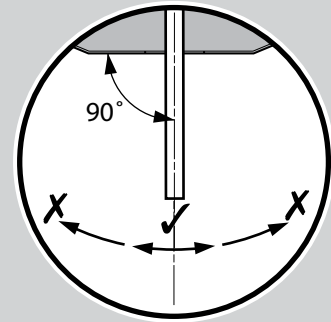
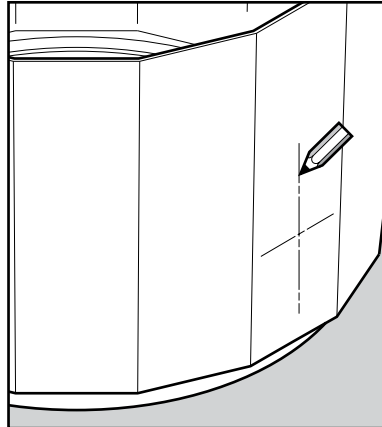

2

Where appropriate, it is recommended that a drill piloted holesaw be used to cut the pipe seal entry hole, Ø150mm, in the sump.

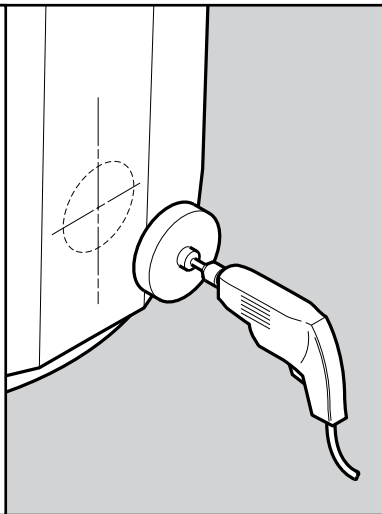

3

Ensure that the gasket is attached to the flange ring which fits on the inside of the chamber wall. Assemble the flange ring set as per diagram.

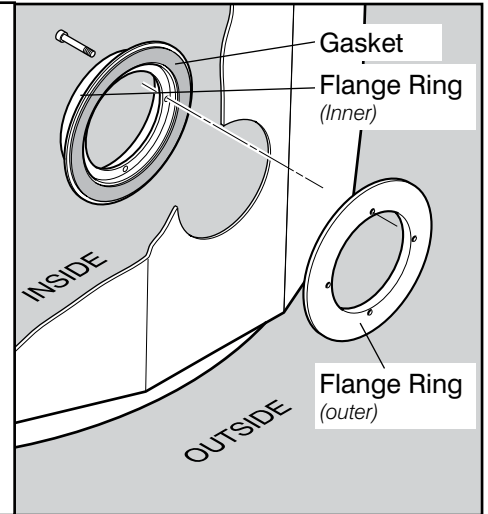

4

Tighten the socket cap screws with an Allen key.

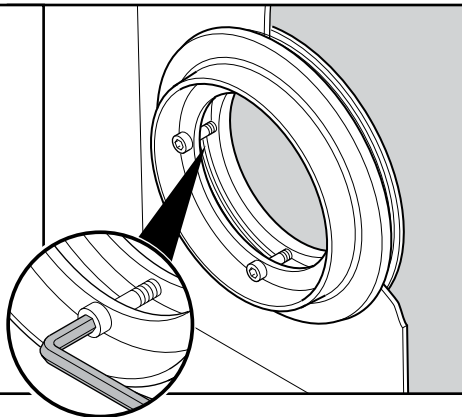

5

Fit the entry boot to the flange ring and secure with the flange ring clip provided. Tighten clips.

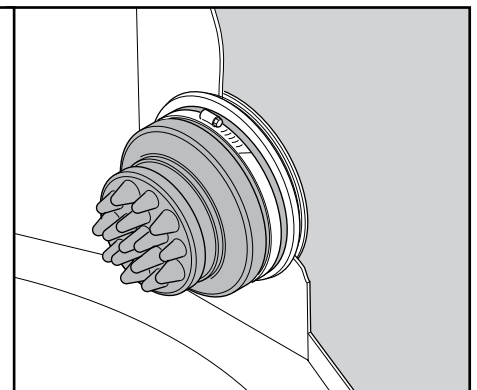

6

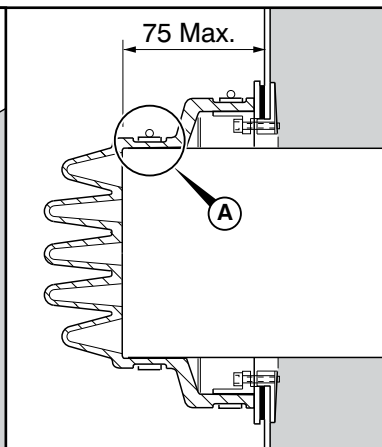
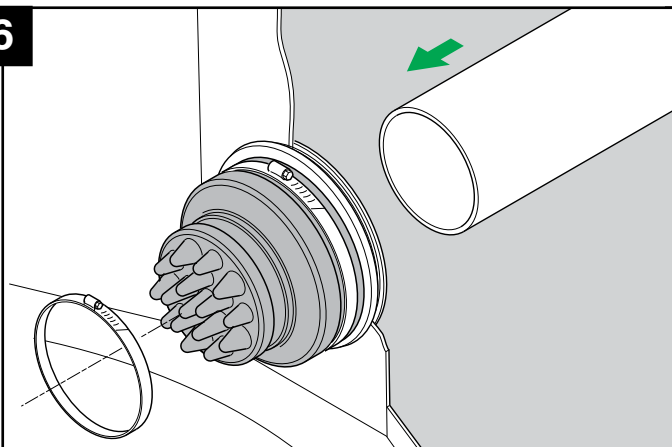

Fit the 100mm diameter ducting into the gaiter and secure the clip.

NB: Failure to effect a seal at point 'A' between the gaiter and ducting may lead to leaks.

## Cable Fitting

7

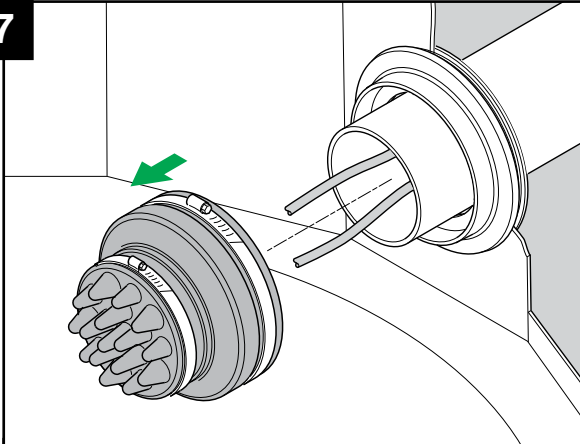

Loosen both clips and remove the entry boot to expose the cables.

8

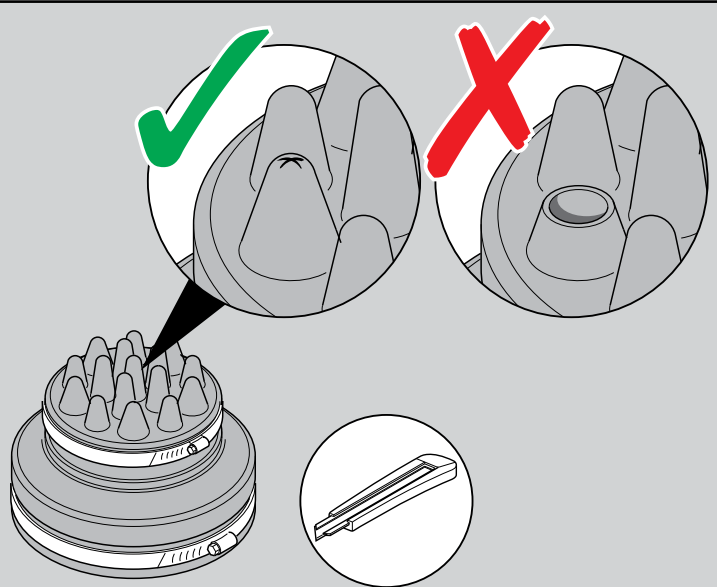

Using a sharp knife pierce a hole in the very end of the nipple you want the cable to run through.

9

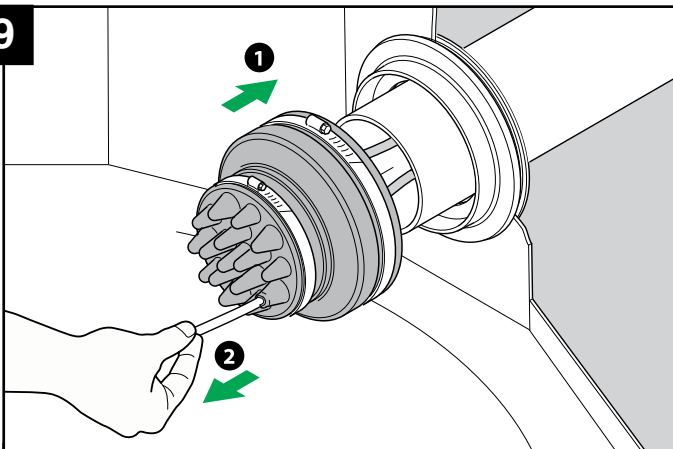

Pull the cables through individual pierced nipples and fit the rubber entry boot back onto the flange. Tighten clips to secure.

10

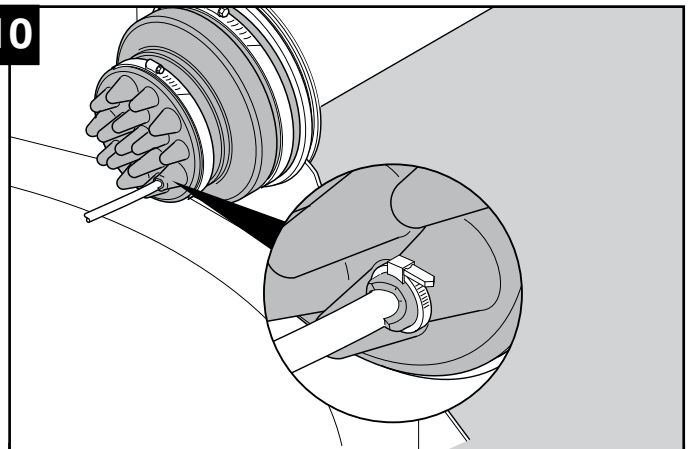

Seal the cable by securing with a cable tie.