

FITTING INSTRUCTIONS

Pipe Sealkits

NB: Where appropriate, it is recommended that a drill piloted hole saw be used to cut the pipe/cable seal entry hole in the chamber.

Angles of flexible entry sleeves must not exceed 12° from centre line (24° inclusive angle).

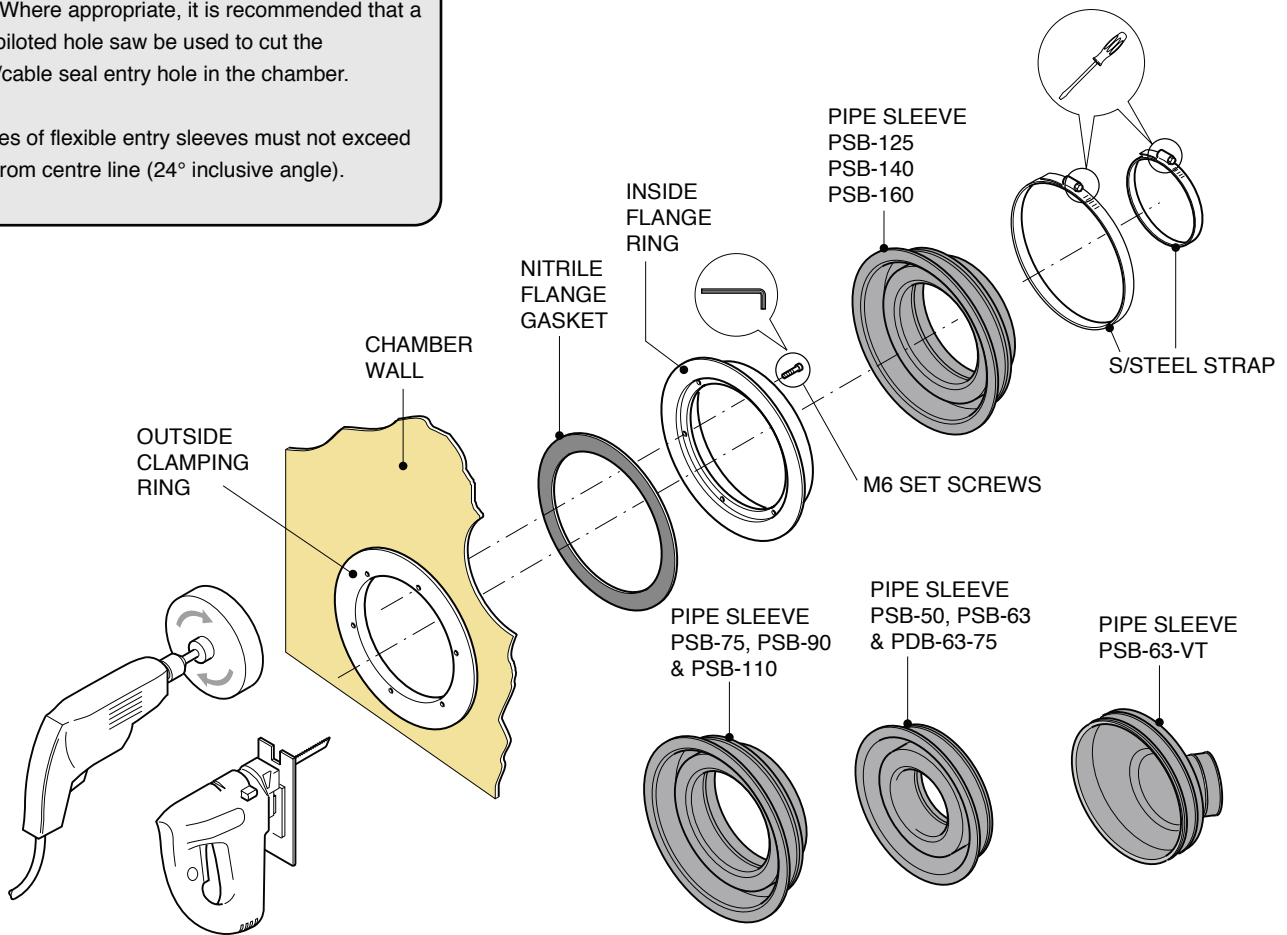

DRILL AND HOLE SAW
ATTACHMENT OR JIGSAW

NB: Straps/clips are to be tightened in accordance with the pipe manufacturers recommendation

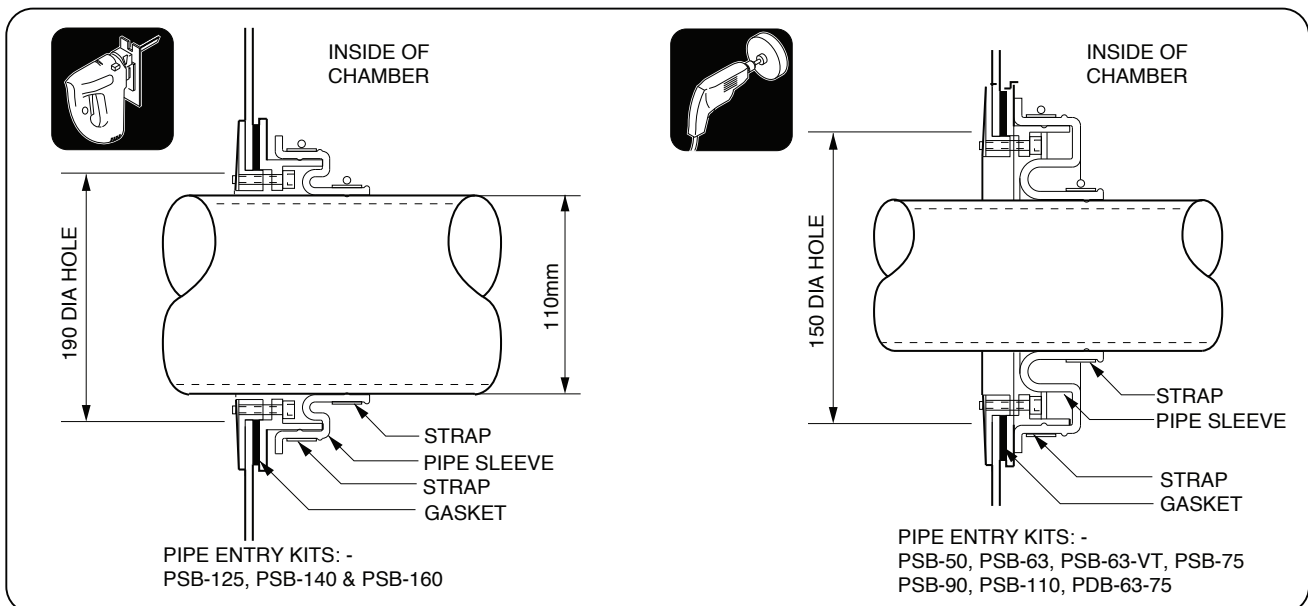

The exit position of the pipework through the chamber wall must be as close as possible to 90°. The pipe kit should be fitted so that the pipework is centrally positioned to the seal. When backfilling ensure that the pipework is not disturbed from this central position.