

PLEASE HAND TO SITE OPERATOR

**WARNING**

Care must be taken not to twist the frames. Please check the cover to frame interface prior to concreting. The underside of the frame must be fully supported in concrete.

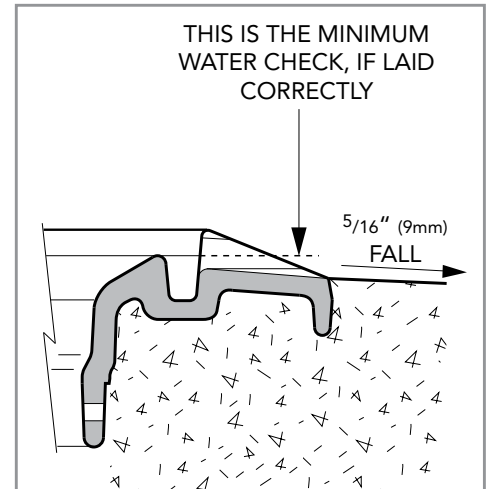
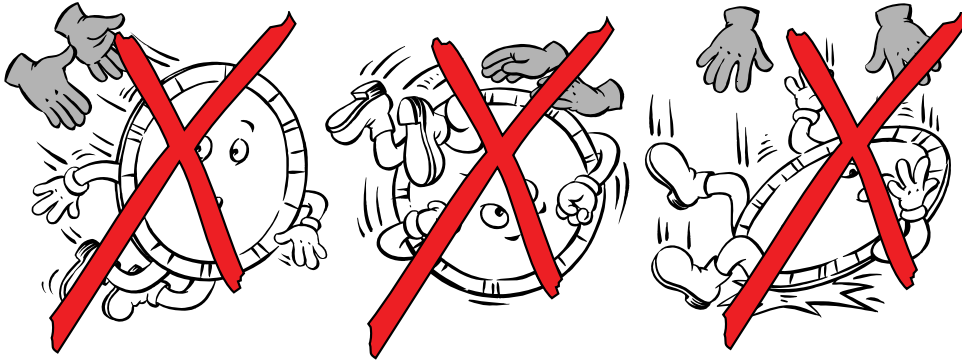

**FITTING INSTRUCTIONS**

**VERY IMPORTANT**

OUTER EDGE "A" OF FRAME SET 1/4 - 1/2" (5-10mm) ABOVE GENERAL FORECOURT AREA WITH CONCRETE RAMPED AWAY OVER 12" (300mm).

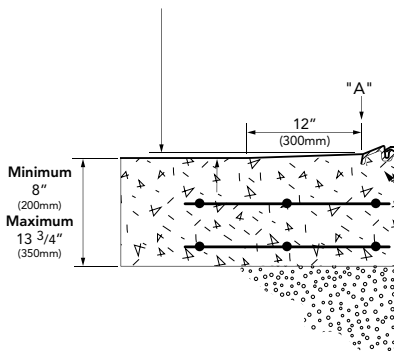

**NOTES**

The concrete surrounding the "Drain Off" section must be worked so that it forms a natural drain and does not prevent the natural dispersion of rain water from the water check channel, without exposing the edges of the frame to vehicular traffic. The remaining "Drain Off" sections must be concreted as normal.

The water check channel and designated "Drain Off" section must be kept free from concrete and debris.

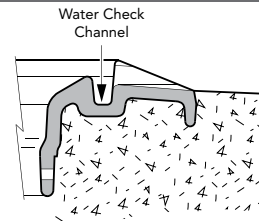

**VERY IMPORTANT**  
The underside of the frame must be adequately supported by concrete.

Work concrete under frame for correct support.

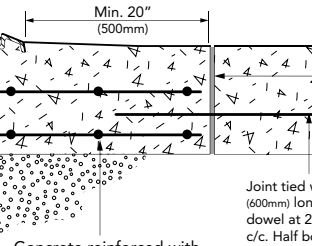

Expansion joint filled with petrol resistant mastic.

Concrete reinforced with 2 layers of reinforcement mesh.

TYPICAL INSTALLATION

**WARNING**

Prior to installation inspect the frame for any distortion. To do this place the frame onto a stable, flat surface and place the cover into the frame. Walk around the circumference of the cover applying pressure with your foot to the cover edge to ensure it does not rock within the frame. If the frame appears warped or bent, contact the distributor and have it replaced.

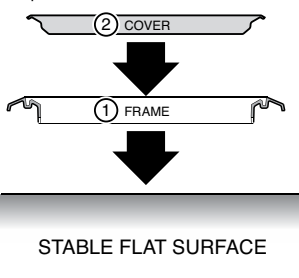

**DRAINAGE FEATURE**

The frame must be installed so that one of these "Drain Off" sections is positioned at the lowest point of the grade incline.

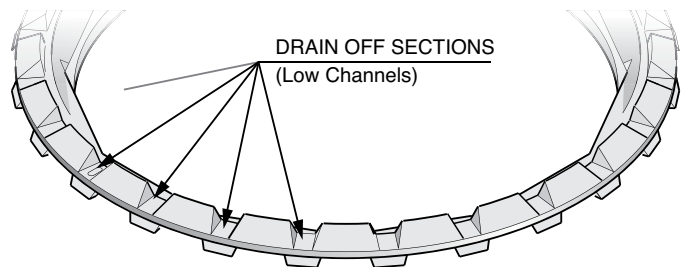

We've got you covered