

# REPLACEMENT INSTRUCTIONS

## Roto Lock - Removal and Replacement



**NB:** Remove the cover to a safe working area outside the Zone 2 and cover the open manhole and barrier off. When grinding, impact safety glasses/goggles and gloves should be worn. When welding, appropriate PPE must be used.

### Removal

1

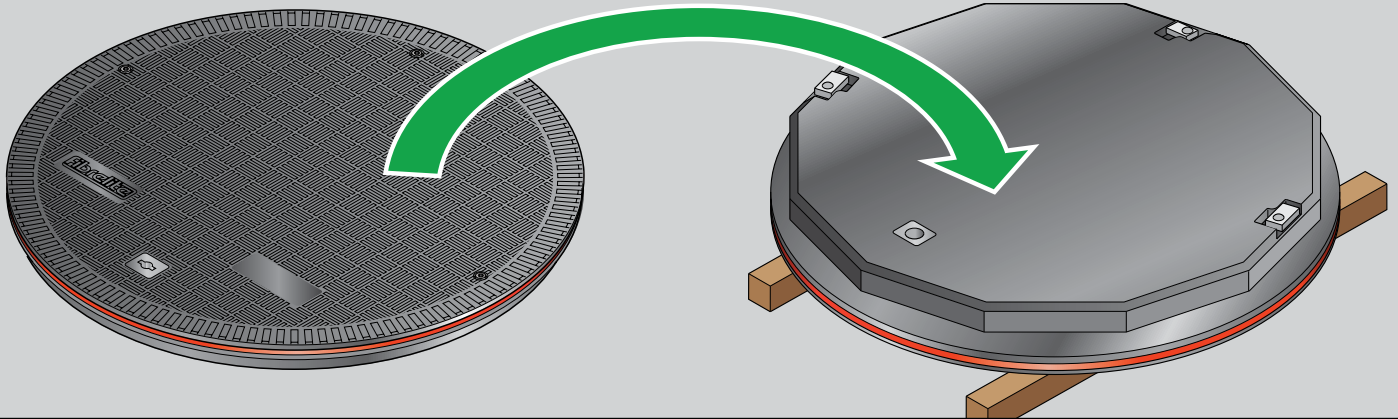

Turn the cover over and elevate using wooden blocks to allow access to the lock paddle and to protect the cover surface.

2

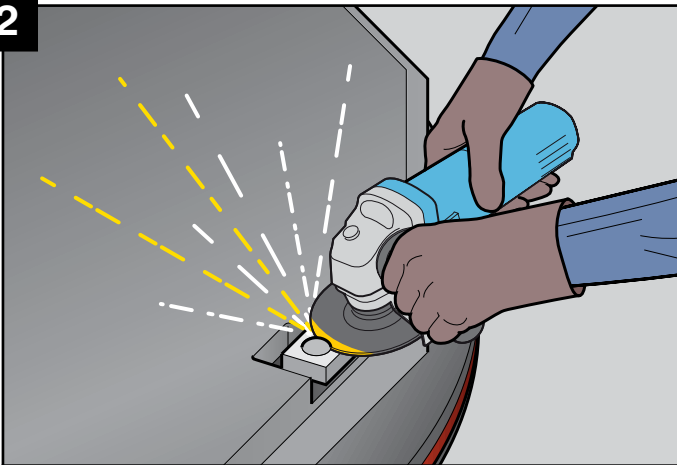

Using a 4" grinder, grind away the weld on the paddle foot.

3

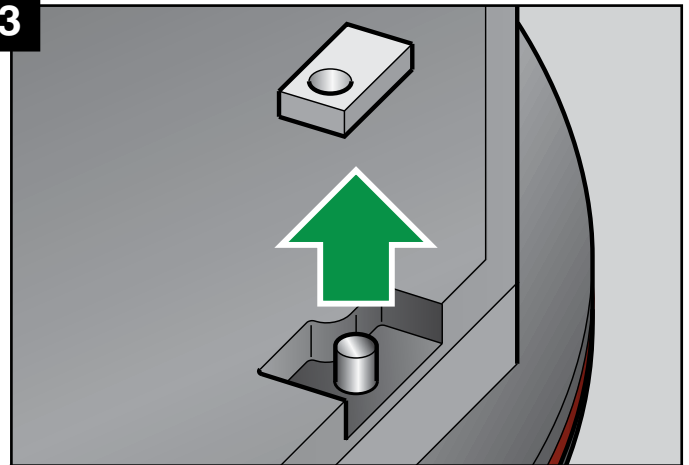

Remove the paddle foot.

4

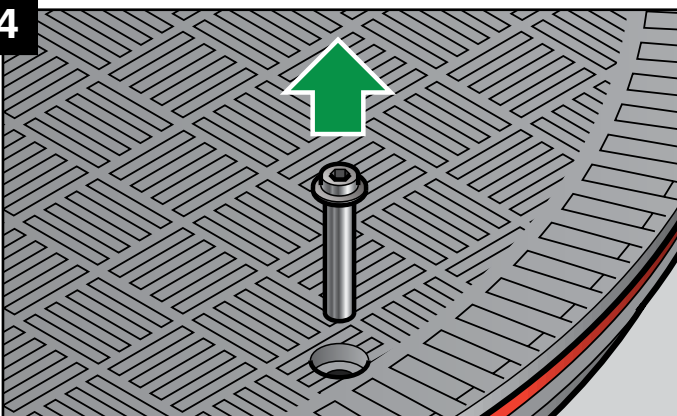

Slide out the bolt from the cover top.

Replacement

