

Frame Assembly

Install the pre-laminated frame as per Figs. 1 and 2.

FIG. 1

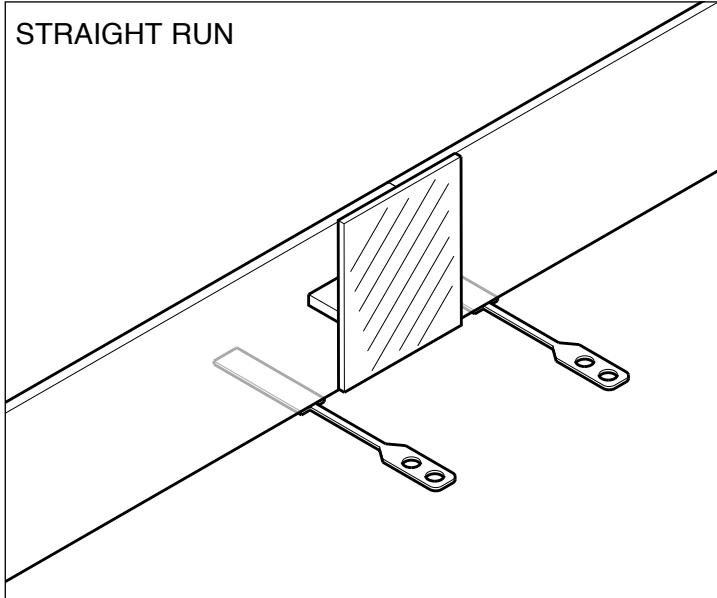
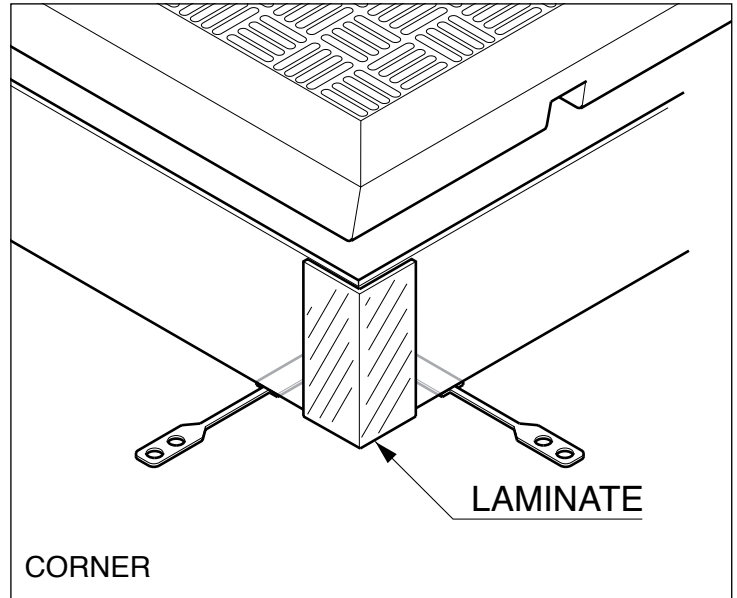
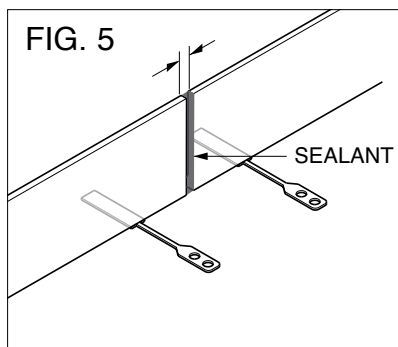

FIG. 2



Installation

It is recommended that prior to concreting the covers are positioned into the frame and the frame is checked for flatness and sizing. On long stretches of trenching gaps may occur at the frame joints (refer to Fig. 5).



This is to allow expansion of the frame and the gaps will be filled with flexible sealant (40FC).

FIG. 3

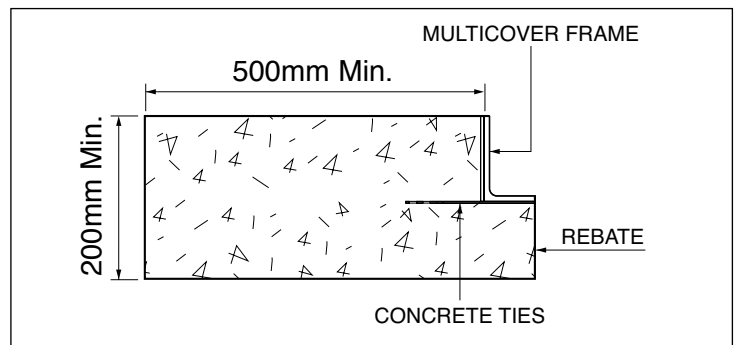
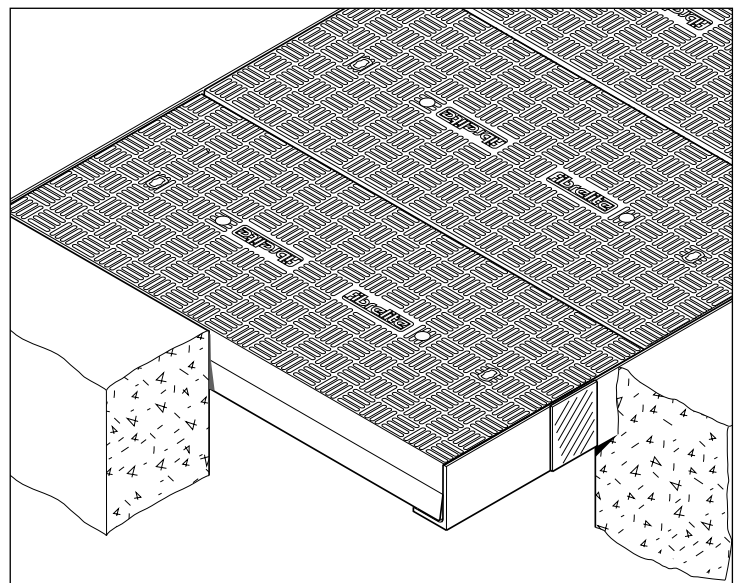

FIG. 4



Create a rebate or Brickwork Footprint. Position the frame onto a bed of mortar, when the mortar is cured enough to sufficiently support the frame the surrounding area is to be concreted to the specified thickness and width with the concrete ties facing outwards (refer to Fig. 3).

NB: When installing for trench application where concrete is to form the ends of the trench the end covers must be positioned into the frame prior to concreting to establish the boundaries. (See Fig.4)