

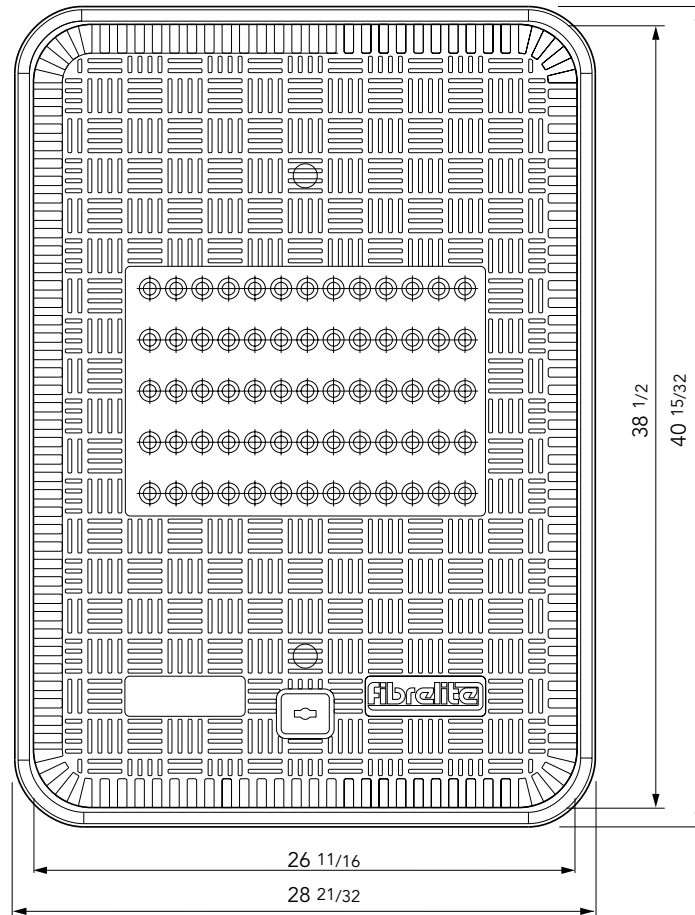

36" x 24" flat, vented composite cover with aluminum frame. Temperature and chemical resistant. Designed for steam applications.

For reference purposes only. This drawing is not a specification. Order against product code only. To enable continuous improvement of our products, the designs and specifications are subject to change without notice.

FIBRELITE 
PART OF OPW A DOVER COMPANY

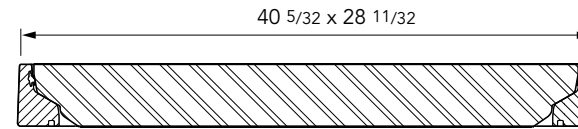
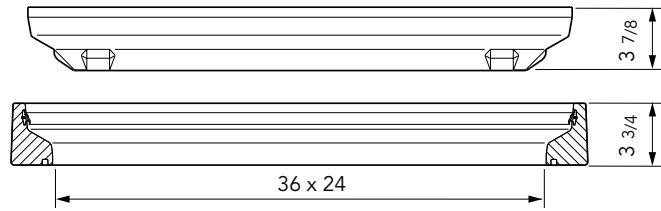

36" x 24" flat, vented composite cover with aluminum frame. Temperature and chemical resistant. Designed for steam applications.

For reference purposes only. This drawing is not a specification. Order against product code only. To enable continuous improvement of our products, the designs and specifications are subject to change without notice.



CONCRETE

VERY IMPORTANT

□□A□□□□□□□□ □□□□□□A□□□□□□□□□□□□
 □□□□□□□□□□□□□□□□A□□□□□□□□□□□□□□
 □□□□□□□□□□□□□□□□A□□□□□□□□□□□□□□
 □□□□□□□□□□□□□□□□A□□□□

VERY IMPORTANT
 To allow for drainage, Fibrelite recommends that the concrete be sloped away from the top outer edge of the frame (A) a minimum of 1/2" over a 12" distance. Do not expose the top outer edge of the frame (A) – the concrete pad must be flush with the top outer edge of the frame.

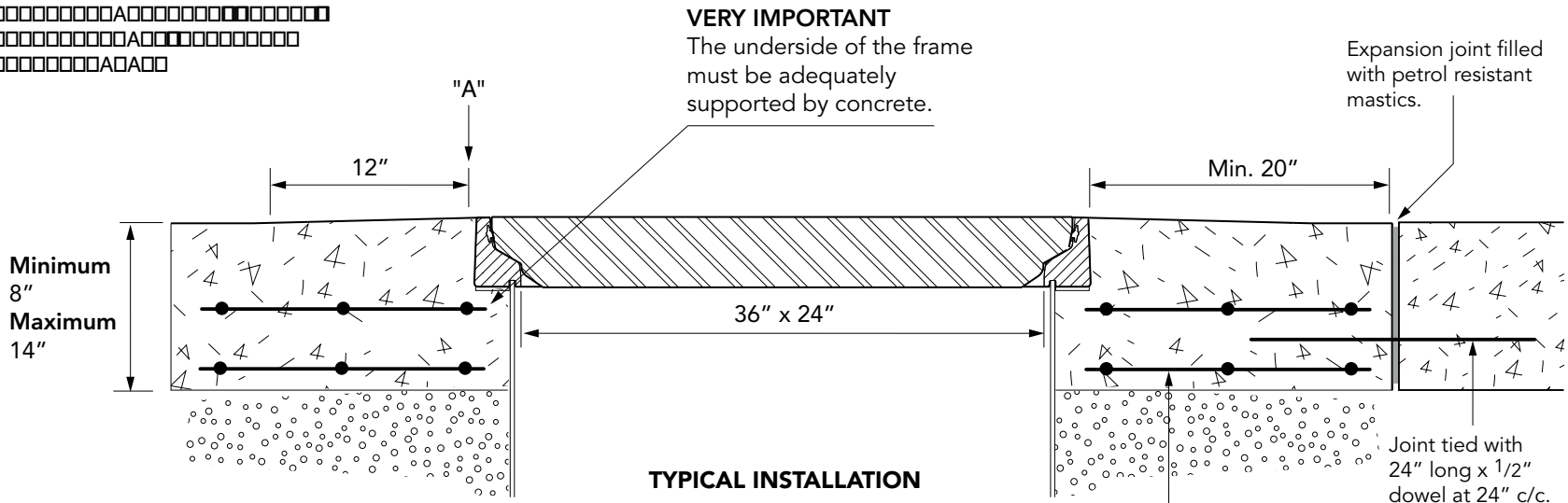

 TARMACADAM  PEA GRAVEL  CONCRETE  SAND

TARMACADAM

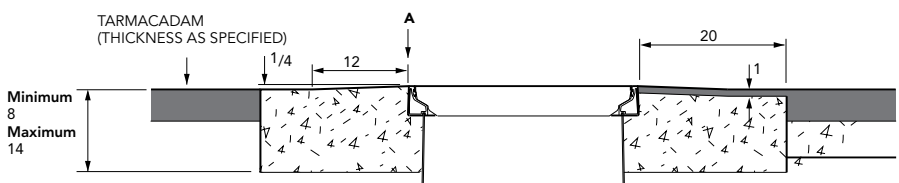

SETTS

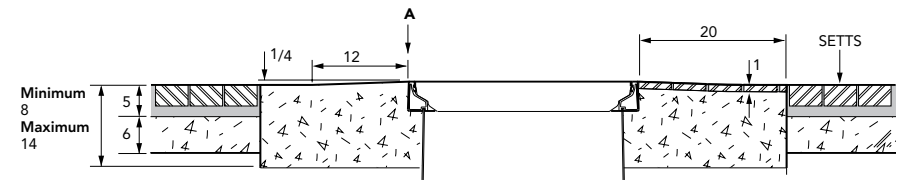

36" x 24" flat, vented composite cover with aluminum frame. Temperature and chemical resistant. Designed for steam applications.

For reference purposes only. This drawing is not a specification. Order against product code only. To enable continuous improvement of our products, the designs and specifications are subject to change without notice.

