

24" x 24" flat sealed composite cover with an aluminum frame.

For reference purposes only. This drawing is not a specification. Order against product code only. To enable continuous improvement of our products, the designs and specifications are subject to change without notice.

**FIBRELITE**   
PART OF OPW A DOVER COMPANY

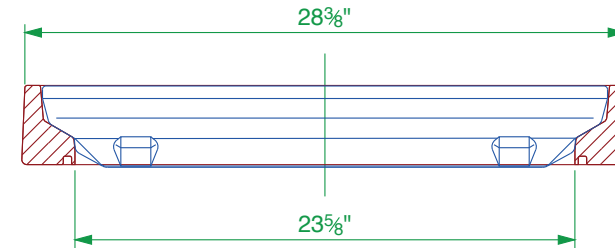
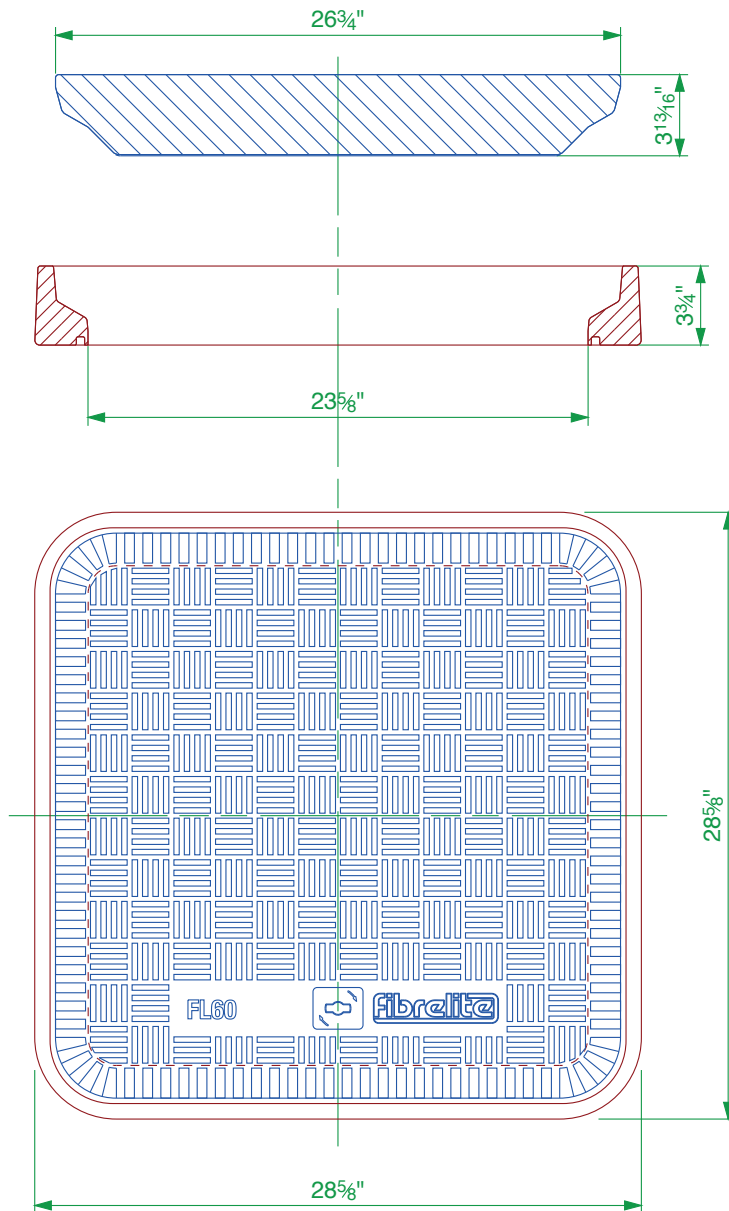

FIBRELITE COVER TYPE	LOAD RATING	TEST LOAD	POUNDS/ FORCE	COVER WEIGHT
Light Duty (LD)	B125	125 kN	28,000	26.5 lbs
Standard Duty (SD)	C250/H20	250 kN	56,000	44.1 lbs
Heavy Duty (HD)	D400/H25	400 kN	89,000	52.9 lbs

24" x 24" flat sealed composite cover with an aluminum frame.

For reference purposes only. This drawing is not a specification. Order against product code only. To enable continuous improvement of our products, the designs and specifications are subject to change without notice.

**FIBRELITE**   
PART OF OPW A DOVER COMPANY

# CONCRETE

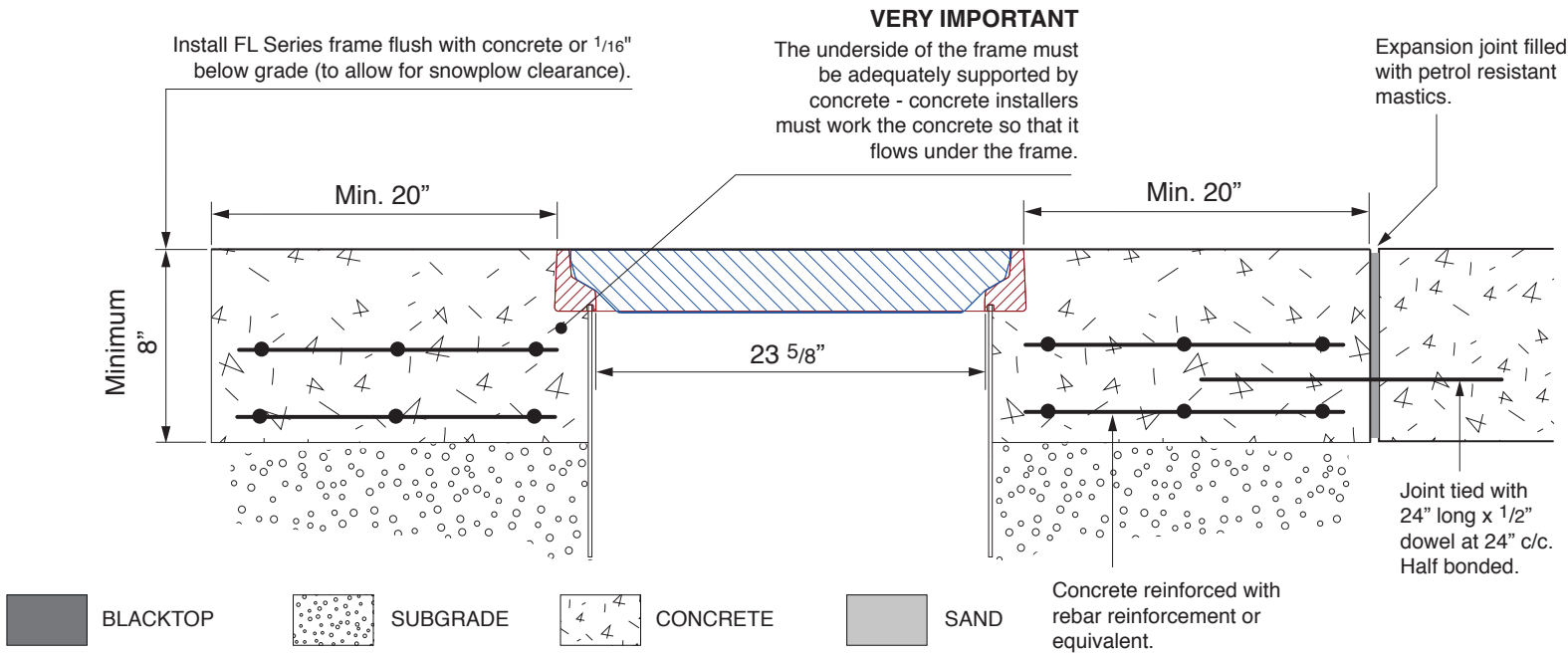

## BLACKTOP

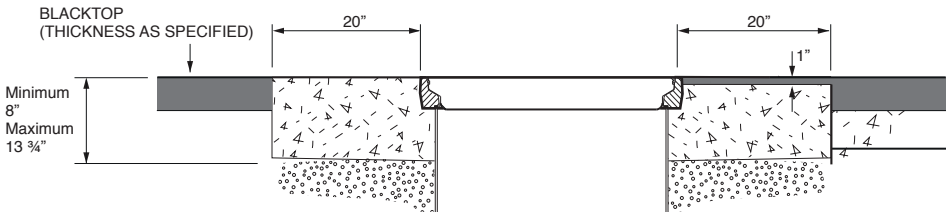

## PAVING STONES / BRICKWORK

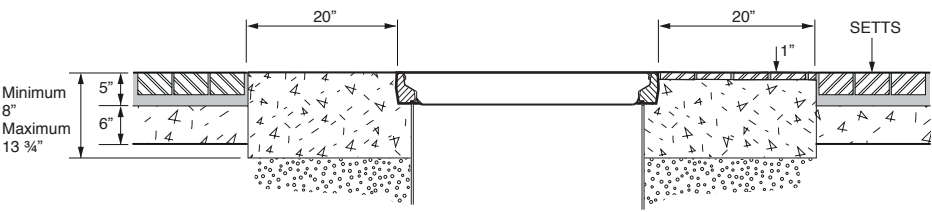

24" x 24" flat sealed composite cover with an aluminum frame.

For reference purposes only. This drawing is not a specification. Order against product code only. To enable continuous improvement of our products, the designs and specifications are subject to change without notice.

**FIBRELITE**  
PART OF OPW A DOVER COMPANY