

Fits up to 5 vent lines

Vent pipe transition sump. 43 5/16 x 19 11/16 x 20 21/32 below ground solid base sump, with 17 23/32 high above ground sealed top with lockable hinged door. Includes pipework support rail and fixings. Order pipe entry boots PSB/75, PSB/63/VT & vent riser mounting brackets MPK-VENT separately.

For reference purposes only. This drawing is not a specification. Order against product code only. To enable continuous improvement of our products, the designs and specifications are subject to change without notice.

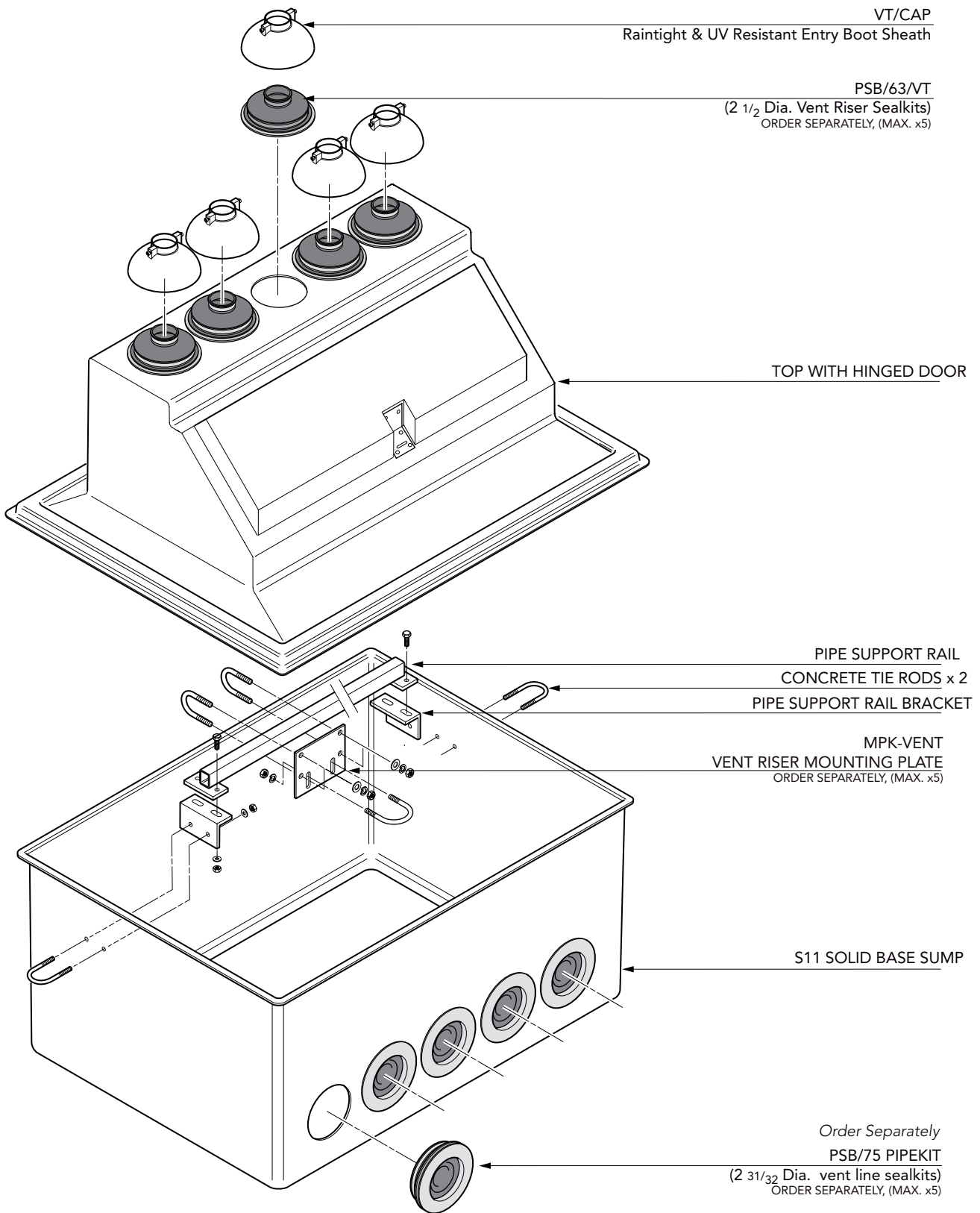

Vent pipe transition sump. 43 5/16 x 19 11/16 x 20 21/32 below ground solid base sump, with 17 23/32 high above ground sealed top with lockable hinged door. Includes pipework support rail and fixings. Order pipe entry boots PSB/75, PSB/63/VT & vent riser mounting brackets MPK-VENT separately.

For reference purposes only. This drawing is not a specification. Order against product code only. To enable continuous improvement of our products, the designs and specifications are subject to change without notice.

FIBRELITE 
PART OF OPW A DOVER COMPANY

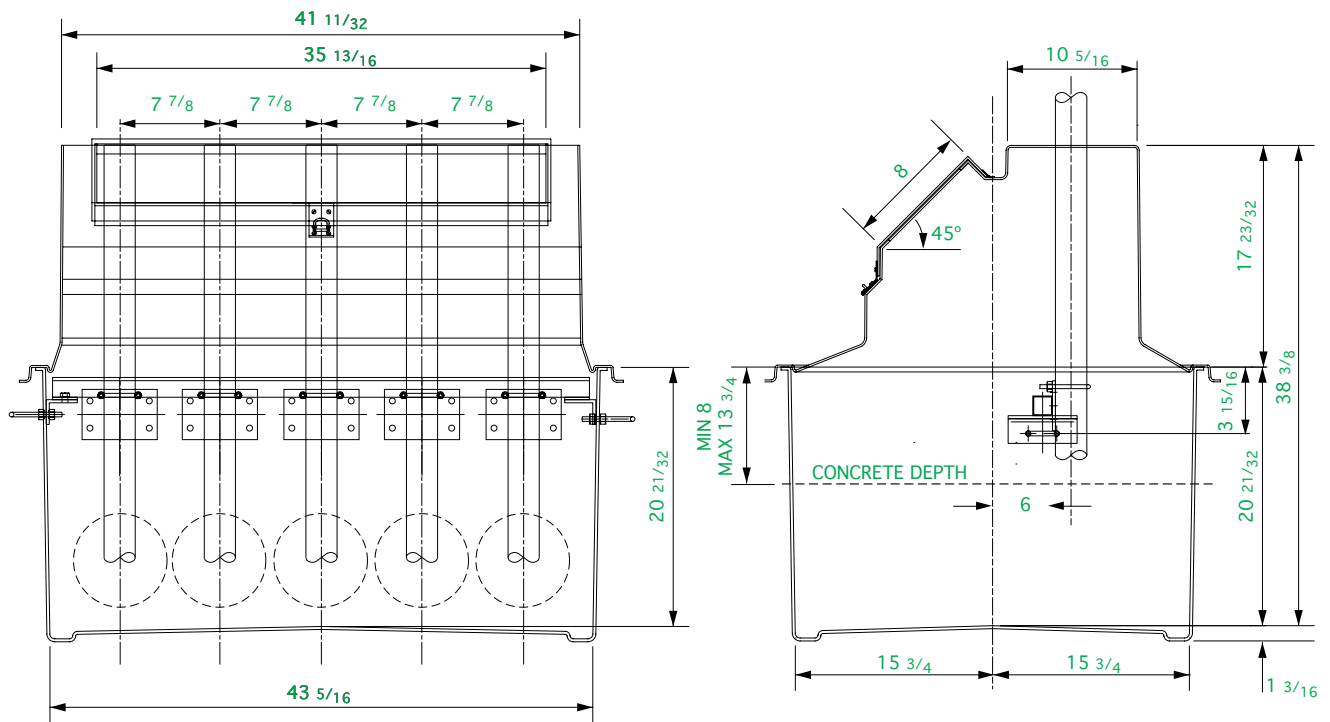

Vent pipe transition sump. $43 \frac{5}{16} \times 19 \frac{11}{16} \times 20 \frac{21}{32}$ below ground solid base sump, with $17 \frac{23}{32}$ high above ground sealed top with lockable hinged door. Includes pipework support rail and fixings. Order pipe entry boots PSB/75, PSB/63/VT & vent riser mounting brackets MPK-VENT separately.

For reference purposes only. This drawing is not a specification. Order against product code only. To enable continuous improvement of our products, the designs and specifications are subject to change without notice.

FIBRELITE 
PART OF OPW A DOVER COMPANY

TYPICAL INSTALLATION

CONCRETE

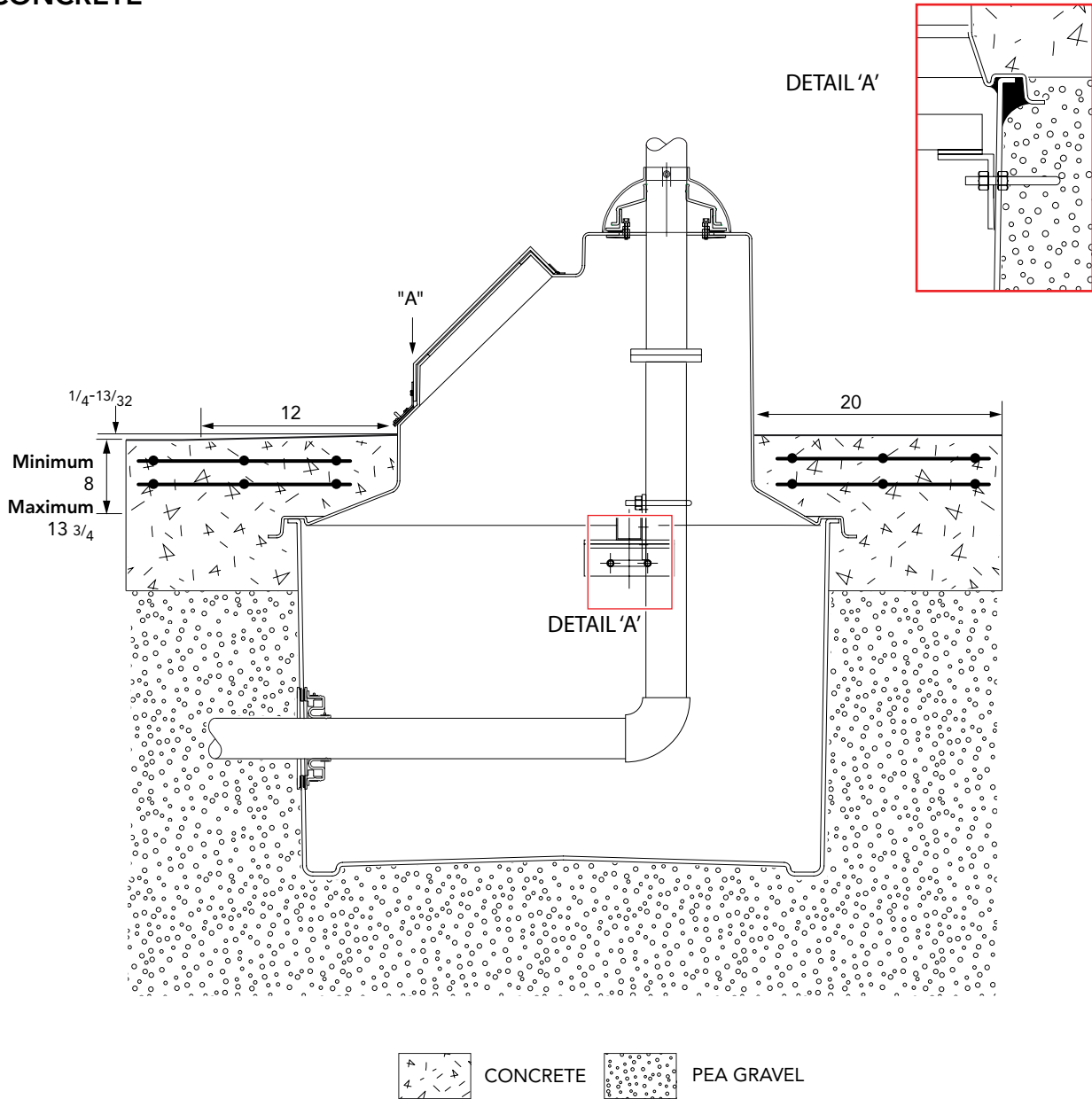

Vent pipe transition sump. 43 5/16 x 19 11/16 x 20 21/32 below ground solid base sump, with 17 23/32 high above ground sealed top with lockable hinged door. Includes pipework support rail and fixings. Order pipe entry boots PSB/75, PSB/63/VT & vent riser mounting brackets MPK-VENT separately.

For reference purposes only. This drawing is not a specification. Order against product code only. To enable continuous improvement of our products, the designs and specifications are subject to change without notice.

FIBRELITE 
PART OF OPW A DOVER COMPANY